

WILTWYCK QUILTERS GUILD

WALKER POCKET INSTRUCTIONS

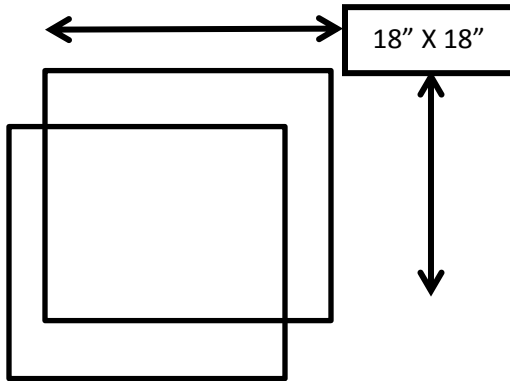

(1) CUT TWO

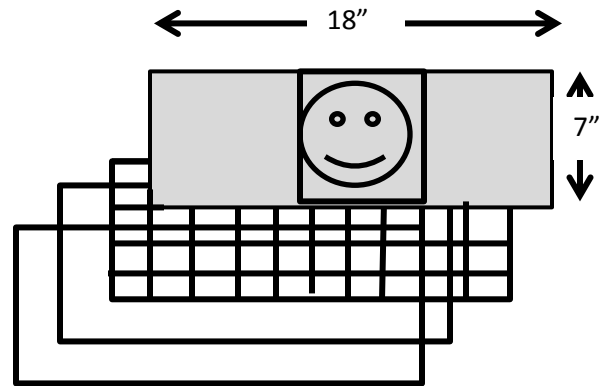

(2) CUT FOUR

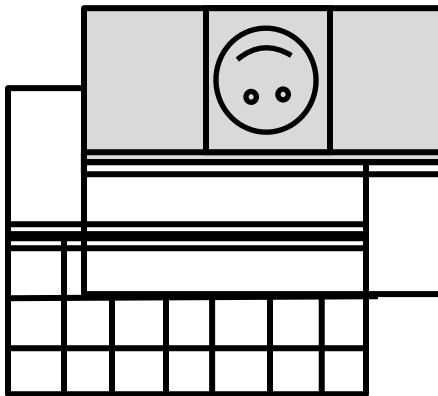

(3) SEW SEAMS

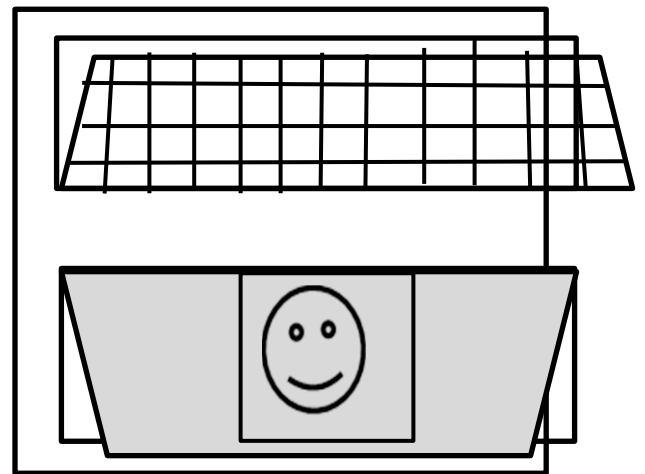

(4) PLACE ON RIGHT SIDE OF BACKING PIECE

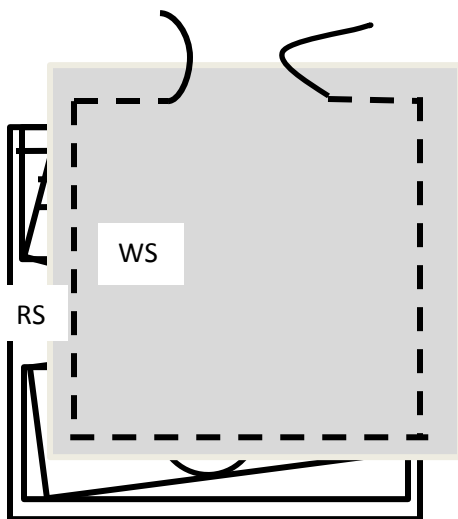

- (5) Combine, machine stitch around edge and leave a large enough opening to turn right side out.**
- (6) Turn through opening. Sew opening closed.**
- (7) Center 24" twill tape on each side of pocket.**

